

## TO ALL OUR CUSTOMERS

### 1. NEW OMNIA 63A INTERLOCKED SOCKETS (IEC60309-1 and 2)

The offer for OMNIA Series interlocked sockets has been enlarged. A new 63A socket with mechanical lock and no fuses is manufactured.

The new version, as the already existing 16/32A, is available in the flush and surface mounting versions.

Therefore, the following new products are available:

- OMNIA Series: 63A surface mounting sockets, IP67 (only metric entry)
- OMNIA Series: 63A flush mounting sockets, IP67
- OMNIA Systems: empty box for OMNIA 63A socket, IP67 (only metric entry)

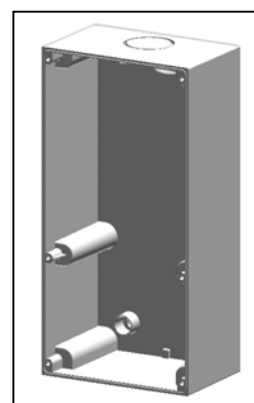

The main features of the product are as follows:

- Degree of protection is IP66/IP67;
- Complete socket dimensions including base: 136x275x187mm;
- ON-OFF lockable knob;
- Disconnecting switch operation control having the following electric features AC22A 63A 690V; AC23A 50A 400V; AC3 40A 400V;
- Modularity with IP66 DOMINO series (refer to next SIS item);
- Modularity with ADVANCE SYSTEM 2 series (it can be fixed to the modular "large" support, code 576.4340);
- Surface mounting version with breakable entry of metric type included in the upper 1xM40 side. The lower side is provided with 2 dimples for max M32 entries;
- Caps for complete insulation are provided with the kit;



New product catalogue numbers are reported below:

Description					Catalogue Number	
					Surface Mounting Version (Metric Entry)	Flush Mounting Version
Poles	Hz	Volt	Colour	h.	<b>63A</b>	<b>63A</b>
2P+G	50/60	100-130	Yellow	4	505.M6370	405.6370
	<b>50/60</b>	<b>200-250</b>	<b>Blue</b>	<b>6</b>	<b>505.M6383</b>	<b>405.6383</b>
	50/60	380-415	Red	9	505.M6378	405.6378
	50/60	480-500	Grey	7	505.M63836	405.63836
	50/60	trasf.	Grey	12	505.M63833	405.63833
3P+G	50/60	100-130	Yellow	4	505.M6372	405.6372
	50/60	200-250	Blue	9	505.M6374	405.6374
	<b>50/60</b>	<b>380-415</b>	<b>Red</b>	<b>6</b>	<b>505.M6386</b>	<b>405.6386</b>
	60	440-460	Red	11	505.M63865	405.63865
	50/60	480-500	Grey	7	505.M63866	405.63866
	50/60	600-690	Black	5	505.M63867	405.63867
3P+N+G	50/60	100-130	Yellow	4	505.M6379	405.6379
	50/60	208-250	blue	9	505.M6375	405.6375
	<b>50/60</b>	<b>346-415</b>	<b>red</b>	<b>6</b>	<b>505.M6387</b>	<b>405.6387</b>
	50/60	480-500	grey	7	505.M63876	405.63876
	50/60	600-690	black	5	505.M63877	405.63877
	60	440-460	red	11	505.M63875	405.63875

Description	Catalogue Number
Empty Surface mounting Box 136x275x89mm	<b>572.M0308</b>

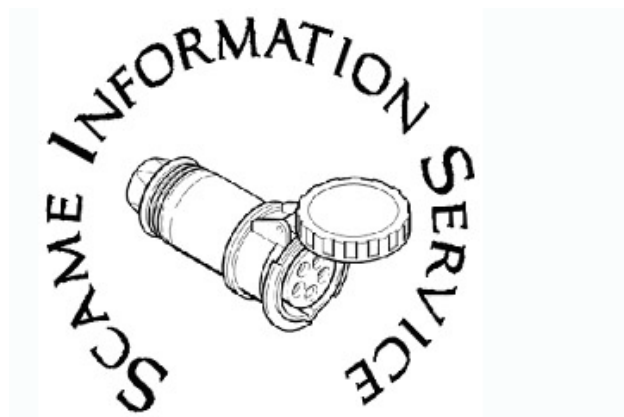

**2. NEW IP66 DOMINO SERIES ENCLOSURE**

In order to also make the new socket 63A OMNIA series with mechanical block modular with the IP66 DOMINO series, the offer for IP66 DOMINO enclosures is extended by creating a product with 16 DIN exchange and 2 16/32A OMNIA series sockets (left side) plus 1 63A OMNIA series socket (right side).

The features of the new enclosure are in line with the IP66 DOMINO series:

- Degree of protection is IP66;
- Dimensions: 550x328x140mm;
- Caps for complete insulation are provided with the kit;
- Cover is provided with hinges;
- Stainless steel and captive screws;
- Height-adjustable DIN guide;
- Door and cover can be sealed;
- Possible Yale lock kit;
- Possible fixing by external brackets kit;

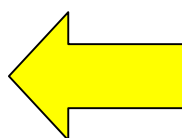

Description	Modularity	Mod. DIN	Catalogue Number
Modular Enclosure - IP66 – for 2 16/32A sockets + 1 63A socket	M550	16 DIN	<b>672.5316</b>

**3. PRODUCTS OUT OF PRODUCTION: TRIS AND ROLLER 330 WITHOUT CUT-OUT SWITCH**

Observing prescriptions reported in the new edition of the European EN61242 standard, our production does not include anymore TRIS series cable reels and ROLLER series cables reels which are not provided with thermal cut-out switch. Products that are now out of production will be replaced by the corresponding cable reels equipped with such device and are already included in the SCAME catalogue.

Products involved are as follows:

Cat. Num.	Description	replaced by	Catalogue Number
<del>707.2405</del>	<del>Tris 150 5m - 10A Italian Standard</del>		<del>709.2405</del>
<del>707.2505</del>	<del>Tris 150 5m - 10A Italian Standard</del>		<del>709.2505</del>
<del>707.2605</del>	<del>Tris 150 4m - 16A Italian Standard</del>		<del>709.2605</del>
<del>707.3310</del>	<del>Tris 190 10m - 16A Italian Standard</del>		<del>709.3310</del>
<del>707.3410</del>	<del>Tris 190 10m - 10A Italian Standard</del>		<del>709.3410</del>
<del>707.3415</del>	<del>Tris 190 15m - 10A Italian Standard</del>		<del>709.3415</del>
<del>707.3510</del>	<del>Tris 190 10m - 10A Italian Standard</del>		<del>709.3510</del>
<del>707.3610</del>	<del>Tris 190 10m - 16A Italian Standard</del>		<del>709.3610</del>
<del>707.3705</del>	<del>Tris 190 5m - 16A Italian Standard</del>		<del>709.3705</del>
<del>707.3710</del>	<del>Tris 190 10m - 16A Italian Standard</del>		<del>709.3710</del>
<del>707.4320</del>	<del>Tris 230 20m - 16A Italian Standard</del>		<del>709.4320</del>
<del>707.4420</del>	<del>Tris 230 20m - 10A Italian Standard</del>		<del>709.4420</del>
<del>707.4615</del>	<del>Tris 230 15m - 16A Italian Standard</del>		<del>709.4615</del>
<del>707.4620</del>	<del>Tris 230 20m - 16A Italian Standard</del>		<del>709.4620</del>
<del>707.4715</del>	<del>Tris 230 15m - 16A Italian Standard</del>		<del>709.4715</del>
<del>707.4720</del>	<del>Tris 230 20m - 16A Italian Standard</del>		<del>709.4720</del>
<del>707.3810</del>	<del>Tris 190 10m - 16A French Standard</del>		<del>709.3810</del>
<del>707.3910</del>	<del>Tris 190 10m - 16A German Standard</del>		<del>709.3910</del>
<del>707.4820</del>	<del>Tris 230 20m - 16A French Standard</del>		<del>709.4820</del>
<del>707.4920</del>	<del>Tris 230 20m - 16A German Standard</del>		<del>709.4920</del>

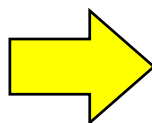
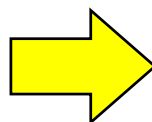

Cat. Num.	Description	replaced by	Catalogue Number
<del>746.3005-388</del>	<del>Roller 330 30m - 16A French Standard</del>		<del>746.3000-388</del>
<del>746.4005-388</del>	<del>Roller 330 40m - 16A French Standard</del>		<del>746.4000-388</del>
<del>746.3005-389</del>	<del>Roller 330 30m - 13A English Standard</del>		<del>746.3000-389</del>
<del>746.4005-389</del>	<del>Roller 330 40m - 13A English Standard</del>		<del>746.4000-389</del>
<del>746.3005-384</del>	<del>Roller 330 30m - 16A German Standard</del>		<del>746.3000-384</del>
<del>746.4005-384</del>	<del>Roller 330 40m - 16A German Standard</del>		<del>746.4000-384</del>
<del>746.3005-010</del>	<del>Roller 330 30m - 16A German and Italian Standard</del>		<del>746.3000-010</del>
<del>746.4005-010</del>	<del>Roller 330 40m - 16A German and Italian Standard</del>		<del>746.4000-010</del>
<del>746.3005-385</del>	<del>Roller 330 30m - 16A German and Italian Standard</del>		<del>746.3000-385</del>
<del>746.4005-385</del>	<del>Roller 330 40m - 16A German and Italian Standard</del>		<del>746.4000-385</del>
<del>746.3005-349</del>	<del>Roller 330 30m - 16A French Standard</del>		<del>746.3000-349</del>
<del>746.4005-349</del>	<del>Roller 330 40m - 16A French Standard</del>		<del>746.4000-349</del>

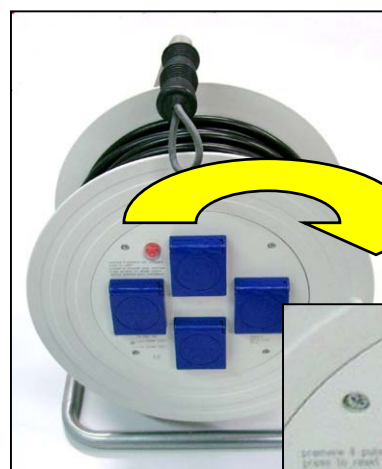
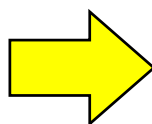
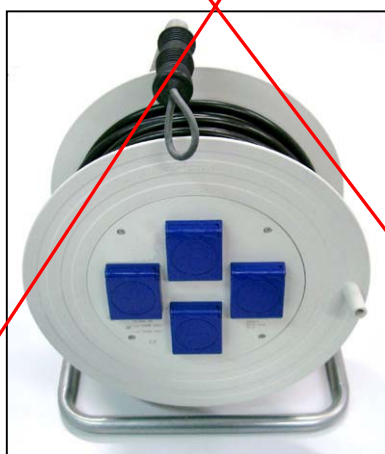
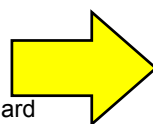

**4. PRODUCT CHANGE: AUTOROLLER SERIES WITH CUT-OUT SWITCH**

In order to observe prescriptions reported in the new edition of the European EN61242 standard, AUTOROLLER series cable reels have been changed and are now provided with a thermal overload protector. Products that are not equipped with such device are out of production and will be replaced by new reels provided with such device. The new product catalogue numbers are as follows:

<b>Cat. Number</b>	<b>Description</b>	<b>replaced by</b>	<b>Catalogue Number</b>
<del>751.0210</del>	<del>with cable - 2 poles - 16m</del>		<del>751.0210-D</del>
<del>751.0215</del>	<del>with cable - 2 poles - 12m</del>		<del>751.0215-D</del>
<del>751.0225</del>	<del>with cable - 2 poles - 10m</del>		<del>751.0225-D</del>
<del>751.0310</del>	<del>with cable - 3 poles - 14m</del>		<del>751.0310-D</del>
<del>751.0315</del>	<del>with cable - 3 poles - 12m</del>		<del>751.0315-D</del>
<del>751.0325</del>	<del>with cable - 3 poles - 8m</del>		<del>751.0325-D</del>
<del>751.1315</del>	<del>with cable, household plugs and sockets</del>		<del>751.1315-D</del>
<del>751.7210</del>	<del>with cable, plug and socket (without transformer)</del>		<del>751.7210-D</del>

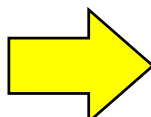

**5. PRODUCT OUT OF PRODUCTION: ACCESSORIES FOR CONDUITS – CONNECTING ELEMENTS IP65**

Some sizes for box – spiral sheath connecting elements are now out of production.

Products that are excluded from production will not be replaced by any other part. Involved parts are as follows:

<b>Cat. Number</b>	<b>Sheath Diameter</b>	<b>Hole</b>
<del>864.602</del>	<del>16mm</del>	<del>PG11</del>
<del>864.604</del>	<del>14mm</del>	<del>PG13,5</del>
<del>864.608</del>	<del>22mm</del>	<del>PG21</del>
<del>864.610</del>	<del>28mm</del>	<del>PG29</del>
<del>864.612</del>	<del>35mm</del>	<del>PG36</del>



The remaining sizes of the range are maintained in production.

SCAME PARRE SPA  
EXPORT DEPT.